

Frequency	1000	Rpm
Amplitude	7.2	mm
Starting current	57.8	Amps per vibrator
Full load current	12.6	Amps per vibrator
Power	4300	Watts
Electrical supply	400,3,50	Volts,Phase,HZ
Equipment weight (total)	2050	Kg
Max static load (kg)	575	Per spring bracket
Max Dynamic load (kg)	90.2	Per spring bracket
Finish Paint Colour	Ral 7004 - Grey	

FOR DRAWING APPROVAL
 FABRICATION AND MANUFACTURE WILL NOT COMMENCE UNTIL WRITTEN APPROVAL OF THIS DRAWING HAS BEEN RECEIVED. ANY DELAY IN RETURNING THE APPROVAL DRAWING CAN RESULT IN A DELAY IN THE DISPATCH OF THE EQUIPMENT .

APPROVED BY	DATE
APPROVED	DISAPPROVAL
COMMENTS	

PLEASE SIGN, DATE AND TICK THE APPROPRIATE BOX AND RETURN AS SOON AS POSSIBLE, WE WOULD EXPECT RECEIPT OF APPROVAL WITHIN 2 DAYS.

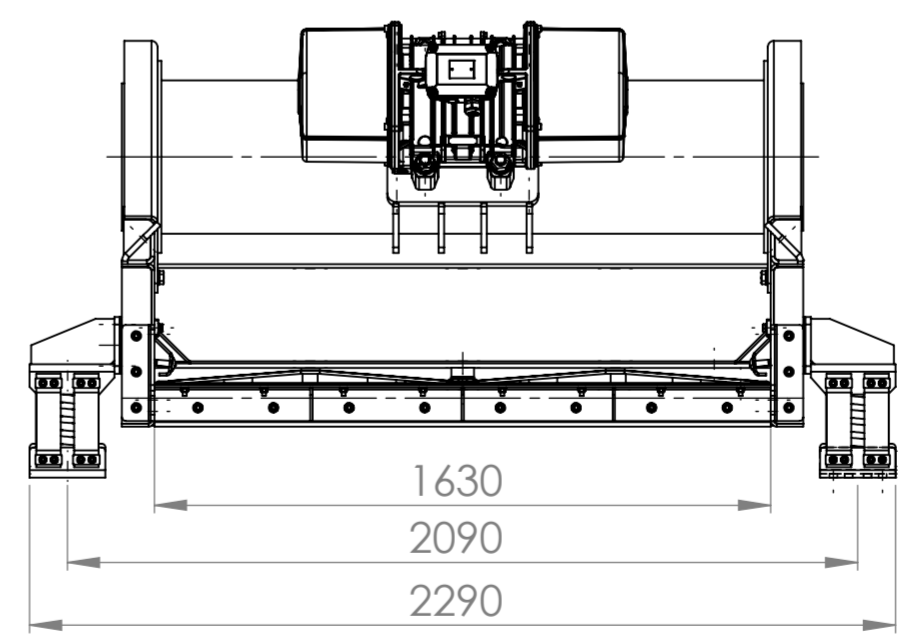

Remove all sharp edges and burrs

THIS DRAWING IS THE PROPERTY OF VIBRAPLANT LTD AND AS SUCH SHOULD NOT BE DISCLOSED, COPIED OR USED FOR MANUFACTURING PURPOSES WITHOUT THE WRITTEN CONSENT OF THE COMPANY.

UNLESS OTHERWISE SPECIFIED: DIMENSIONS ARE IN MILLIMETERS SURFACE FINISH: TOLERANCES: LINEAR: ANGULAR:	FINISH:			DEBURR AND BREAK SHARP EDGES	DO NOT SCALE DRAWING	REVISION
	NAME	SIGNATURE	DATE		TITLE: Single Deck Open Elliptical Screen Model SEO1-1830-4268	
DRAWN				MATERIAL:	DWG NO: SEO1-VP16070	A2
CHKD					SCALE:1:20	SHEET 1 OF 3
APPVD						
MFG						
G.A Vibraplant.co.uk Screening • Feeding • Conveying • Compaction Equipment				WEIGHT: 2046371.00 Kg		

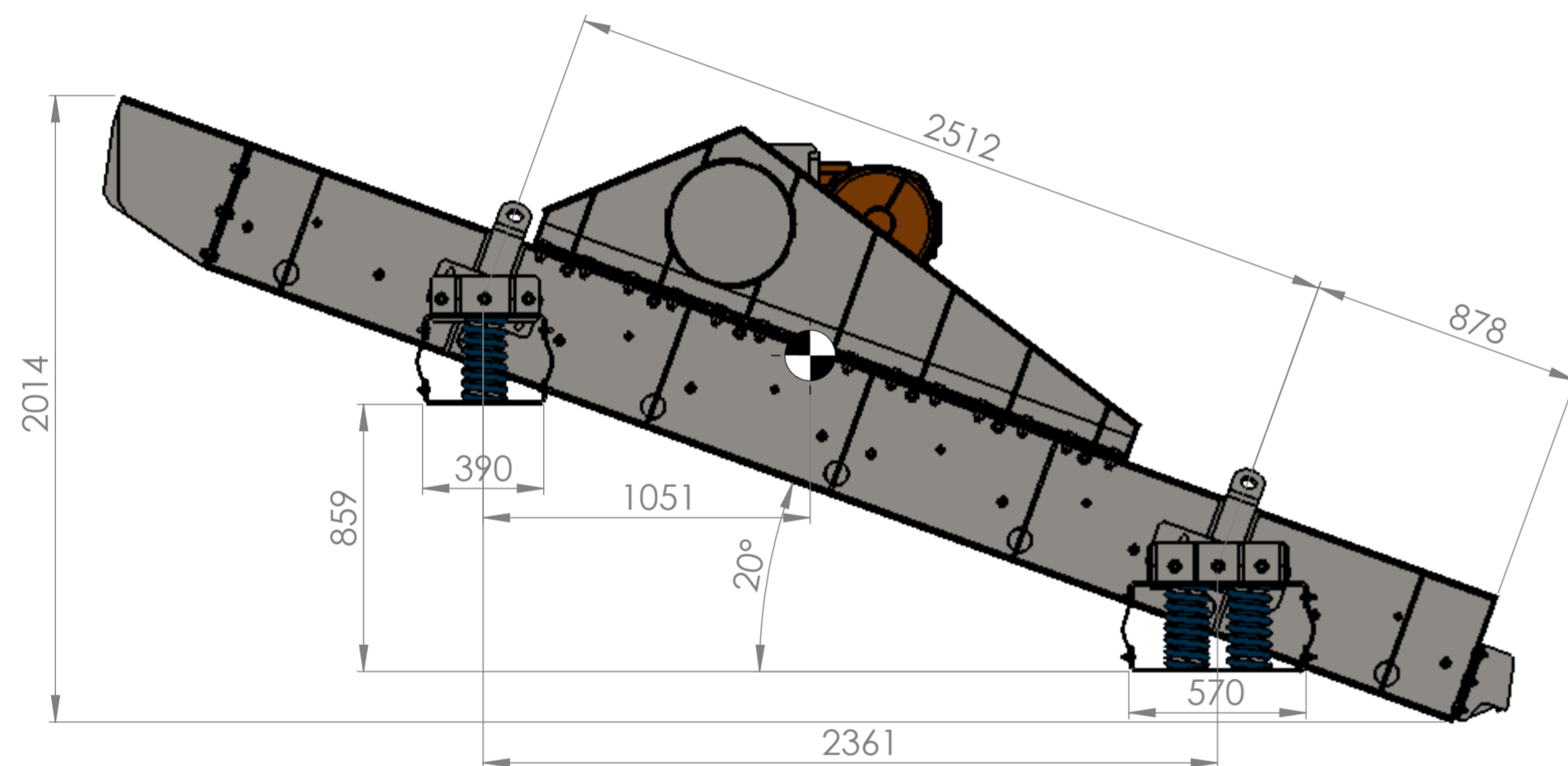

Recommended
Installation Angle
of 20°

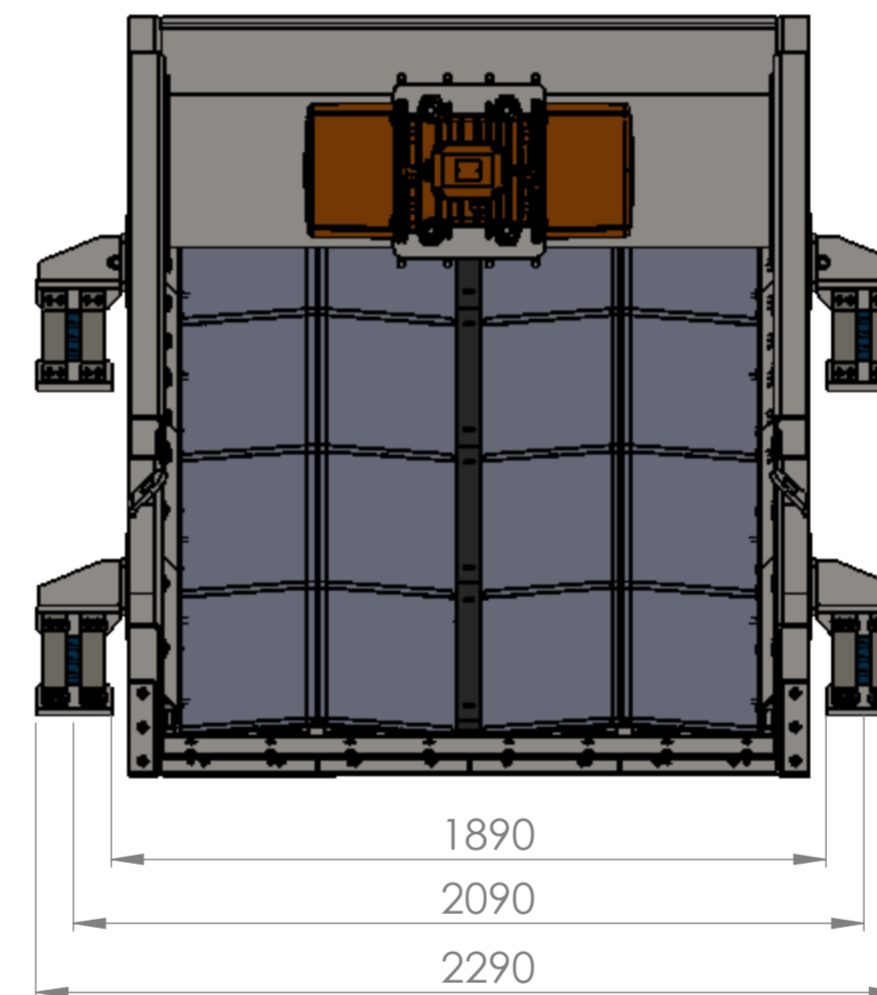

NOTES FOR INSTALLATION
(See manual for full details)

- 1) ENSURE THE EQUIPMENT IS MOUNTED ON A FIRM AND LEVEL SURFACE.
- 2) BOLT THE EQUIPMENT DOWN ENSURING A MINIMUM CLEARANCE OF 50mm BETWEEN STATIC OBJECTS AND 75mm BETWEEN OTHER VIBRATORY OBJECTS
- 3) ONCE INSTALLED ENSURE SPRING BRACKETS ARE LEVEL; REMOVE THE TRANSPORT STRAPS AND FIT SPRING RETAINING STRAPS.
- 4) BEFORE STARTING ENSURE THE UNIT CAN MOVE FREELY ON THE SPRINGS.
- 5) WHEN STARTING CHECK THE VIBRATORS ARE ROTATING IN THE CORRECT DIRECTION:
 - i) TWIN VIBRATORS MUST CONTRA ROTATE TO PRODUCE A LINEAR ACTION.
 - ii) SINGLE VIBRATORS WOULD NORMALLY ROTATE IN A 'WITH FLOW' DIRECTION TO INCREASE MACHINE THROUGHPUT. HOWEVER IF INCREASED RETENTION TIME IS PREFERRED THEN THE VIBRATOR CAN BE REVERSED TO 'COUNTER-FLOW'.
- 6) AFTER APPROXIMATELY 4 HOURS OPERATION CHECK THE FOLLOWING:
 - i) RE-TORQUE THE VIBRATOR FASTENERS IN ACCORDANCE WITH THE TORQUE SETTING STATED IN THE VIBRATOR MANUAL.
 - ii) RE-TORQUE THE SPRING BRACKET BOLTS IN ACCORDANCE WITH THE TORQUE SETTING STATED IN THE EQUIPMENT MANUAL.

UNLESS OTHERWISE SPECIFIED: DIMENSIONS ARE IN MILLIMETERS		FINISH:		DEBURR AND BREAK SHARP EDGES		DO NOT SCALE DRAWING		REVISION	
TOLERANCES: LINEAR: ANGULAR:									
DRAWN	NAME	SIGNATURE	DATE			TITLE:		Single Deck Open Elliptical Screen Model SEO1-1830-4268	
CHK'D						DWG NO.		SEO1-VP16070	
APPV'D						MATERIAL:		A2	
MFG						WEIGHT: 2046371.00 Kg		SCALE: 1:20	
Q.A						SHEET 2 OF 3			

ITEM NO.	16	PART NUMBER	15	DESCRIPTION	13	Hoz./QTY.	12	11	10	9	8	7	6	5	4	3	2	1
100	602092Ax-MVSI 10-8000-S90			Vibratory Motor		1												
101	100-00057-01			Canvas strapping		16												
102	100.00001-23			Compression Springs		6												
103	Type 1 capping rubber			Capping Rubber		20m												
104	100-00010/038			Mesh		4												
200	SMDL-STD-sub-000			Lower spring mount		2												
201	70-DSMU-sub-002			Spring mount assembly		2												
202	SM-STD-008			Strap plate		32												
203	SEO1-16070-sub-001			Main Body		1												
204	SEO1-16070-sub-000			Drive Assembly		1												
205	SEO1-16070-sub-002			In-feed Chute Assembly		1												
206	SEO1-16070-034			Wear Plate		1												
207	SEO1-16070-sub-003			Out-Feed Chute		1												
208	SEO1-16070-049			Out-Feed Liner Plate		1												
209	SEO1-16070-045			Mesh tensioner		8												
210	SEO1-16070-053			Stop block		16												
211	SEO1-16070-057			Clamp strip		4												
212	70-DSMU-sub-002			Spring mount assembly		2												
213	SMDL-STD-sub-001			Lower spring mount		2												
300	BS EN 24033 - M10 - D - N			M10 Nyloc Nut		71												
301	BS EN ISO 10642 - M10 x 30 - 30N			M10 x 30 Countersunk socket cap screw plated		16												
302	BS EN 24033 - M20 - D - N			M20 Nyloc Nut		34												
303	BS EN 24018 - M20 x 55-WN			M20 x 55 Hex Head 8.8 plated		28												
304	Bright washer BS 4320 - M12 (Form A)			M12 Plain washers plated		36												
305	BS EN 24034 - M12 - N			M12 Nyloc Nut		18												
306	BS EN 24018 - M12 x 40-WN			M12 x 40 Hex head 8.8 Plated		18												
307	User Library-m16 x 90 coach bolt			Coach bolt		26												
308	Bright washer BS 4320 - M16 (Form A)			M16 Plain washers plated		25												
309	flat washer narrow_am			M10 Plated Washer		96												
310	BS EN 24018 - M20 x 65-WN			M20 x 65 Hex head 8.8 plated		4												
311	Bright washer BS 4320 - M10 (Form A)			M10 Plain washer		112												
312	flat washer narrow_am			M16 BZP Plain Washer		28												
313	ISO 10642 - M10 x 35 --- 35N			M10 x 35 CSK Socket cap		16												
314	B18.2.4.6M - Heavy hex nut, M16 x 2 -W-N			M16 Nyloc Nut		8												
315	B18.2.3.2M - Formed hex screw, M16 x 2.0 x 45 -45WN			M16 x 45 Hex Head 8.8		8												
316	B18.2.3.2M - Formed hex screw, M12 x 1.75 x 35 -35WN			M12 x 35 Hex Head 8.8		14												
317	M27 Heavy Gauge washer			Washer		12												
318	M27 Nut nyloc			Nyloc nut		6												
320	hex nut style 1_am			M10 BZP Nyloc Nut		32												
321	hex cap screw_am			M16 x 45 BZP Grade 8.8 Hex HD		6												
322	socket head cap screw_am			M16 x 40 Socket Cap Screw Plated		8												
323	B18.22M - Plain washer, 12 mm, narrow			M12 Plain Washer (Form C)		34												
324	B18.2.3.1M - Hex cap screw, M12 x 1.75 x 45 -45N			M12 x 45 Hex Head 8.8		6												
325	hex nut heavy_am			M16 BZP Nyloc Nut		8												
326	BS EN 24033 - M16 - W - N			M16 Nyloc Nut		25												
327	BS EN 24018 - M10 x 35-WN			M10 x 35 Hex Head 8.8		54												
328	Bright washer BS 4320 - M20 (Form A)			M20 Plain Washer Plated		62												
329	hex nut style 1_am			M12 Plated Washer		26												
330	prevailing torque hex nut_am			M10 BZP Nyloc Nut		16												
331	prevailing torque hex nut_am			M12 BZP Nyloc Nut		6												
332	M27x190			Hex screw		4												
333	Plain washer, 20 mm, narrow			M20 Plain Washer (Form C)		81												
334	hex cap screw_am			M27 x 190 BZP Grade 8.8 Hex HD		4												
335	hex cap screw_am			M10 x 40 BZP Grade 8.8 Hex HD		32												
336	hex cap screw_am			M20 x 50 BZP Grade 8.8 Hex HD		20												

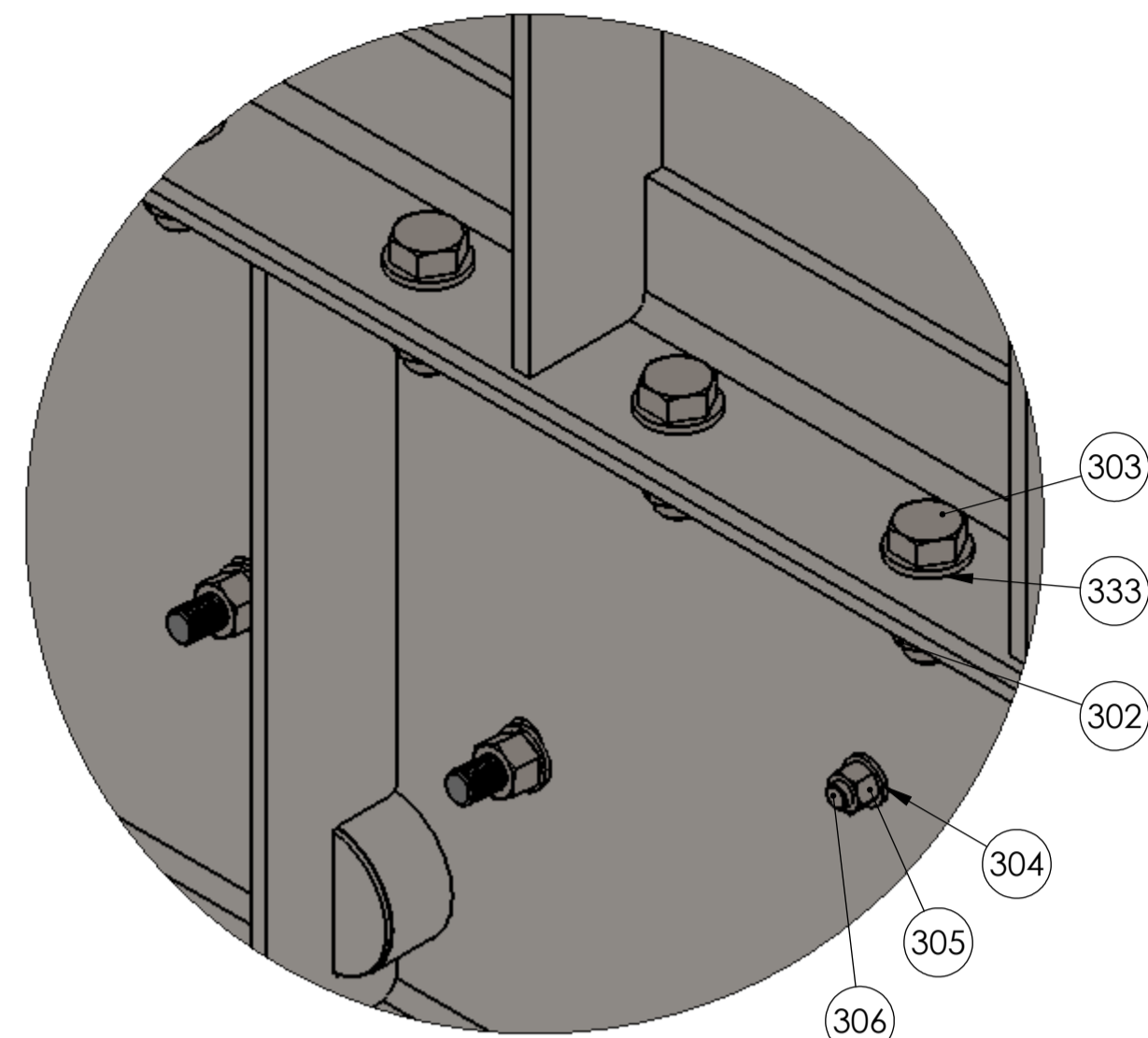

DETAIL G SCALE 1 : 3

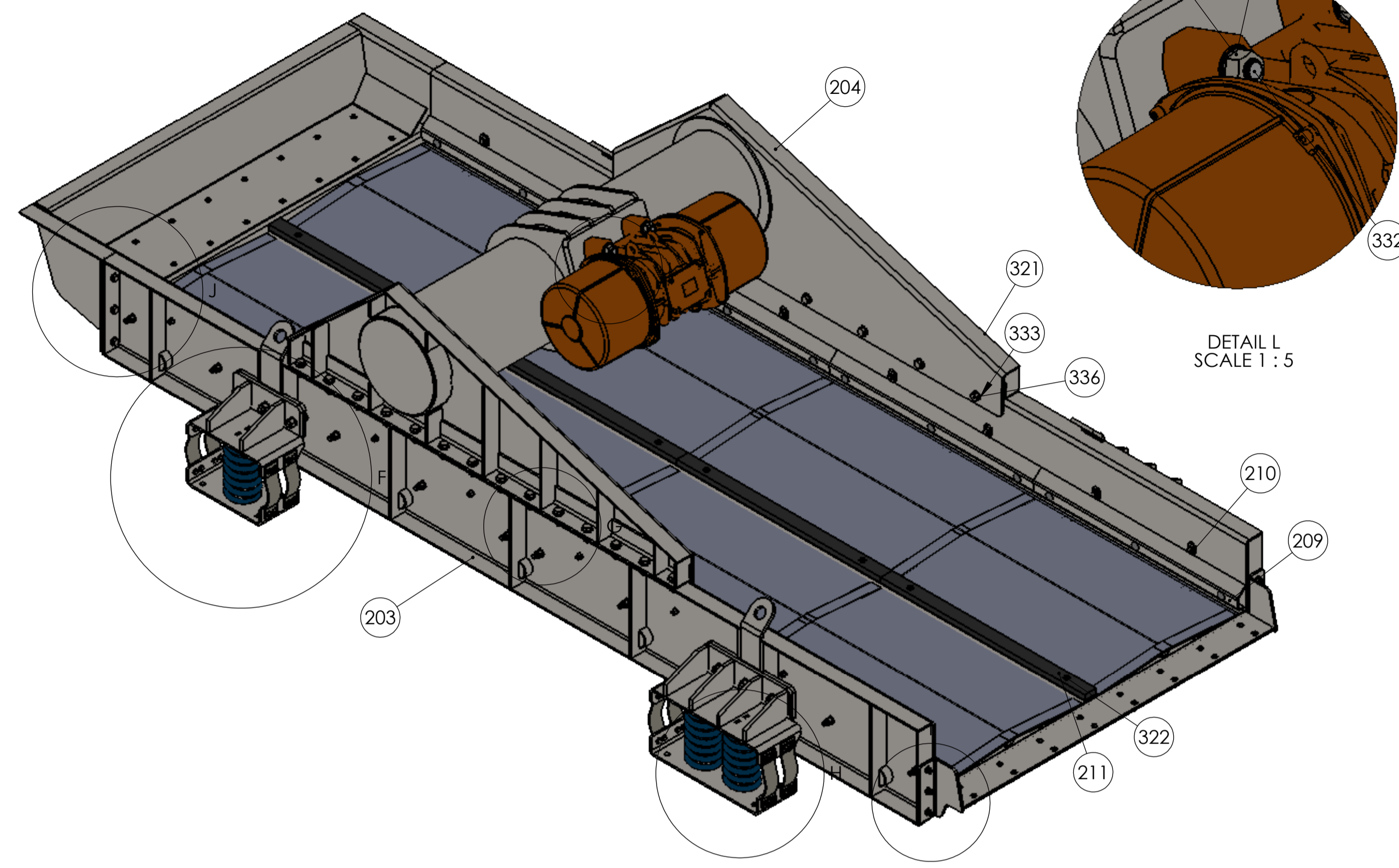

DETAIL L SCALE 1 : 5

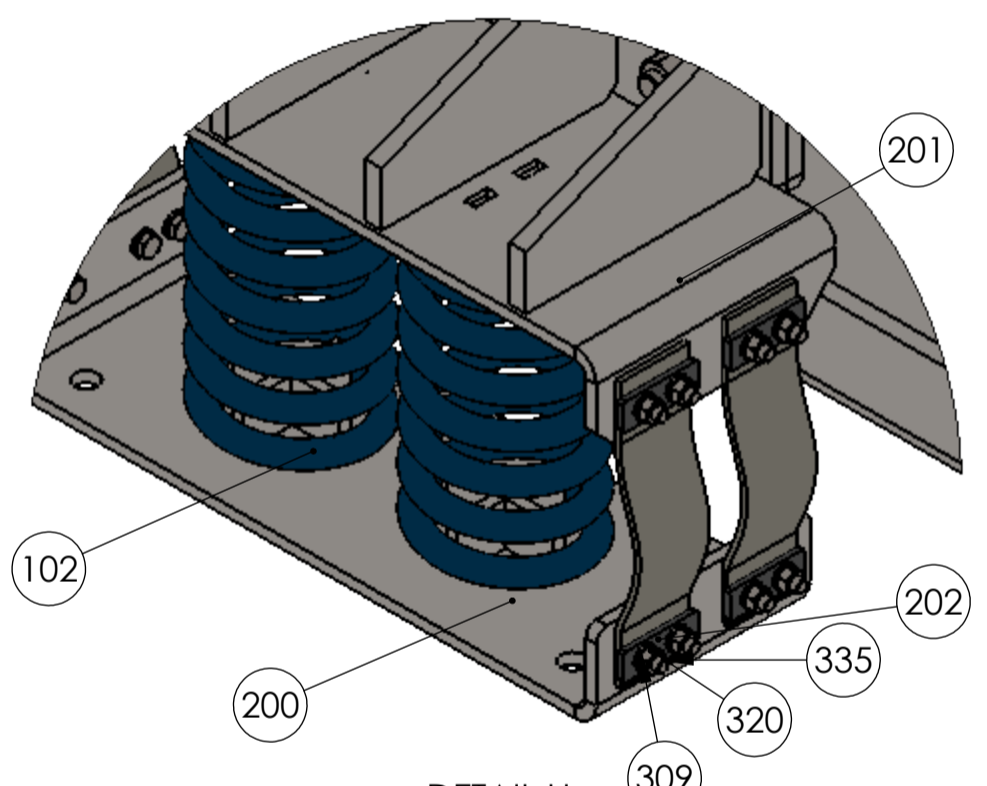

DETAIL H SCALE 1 : 5

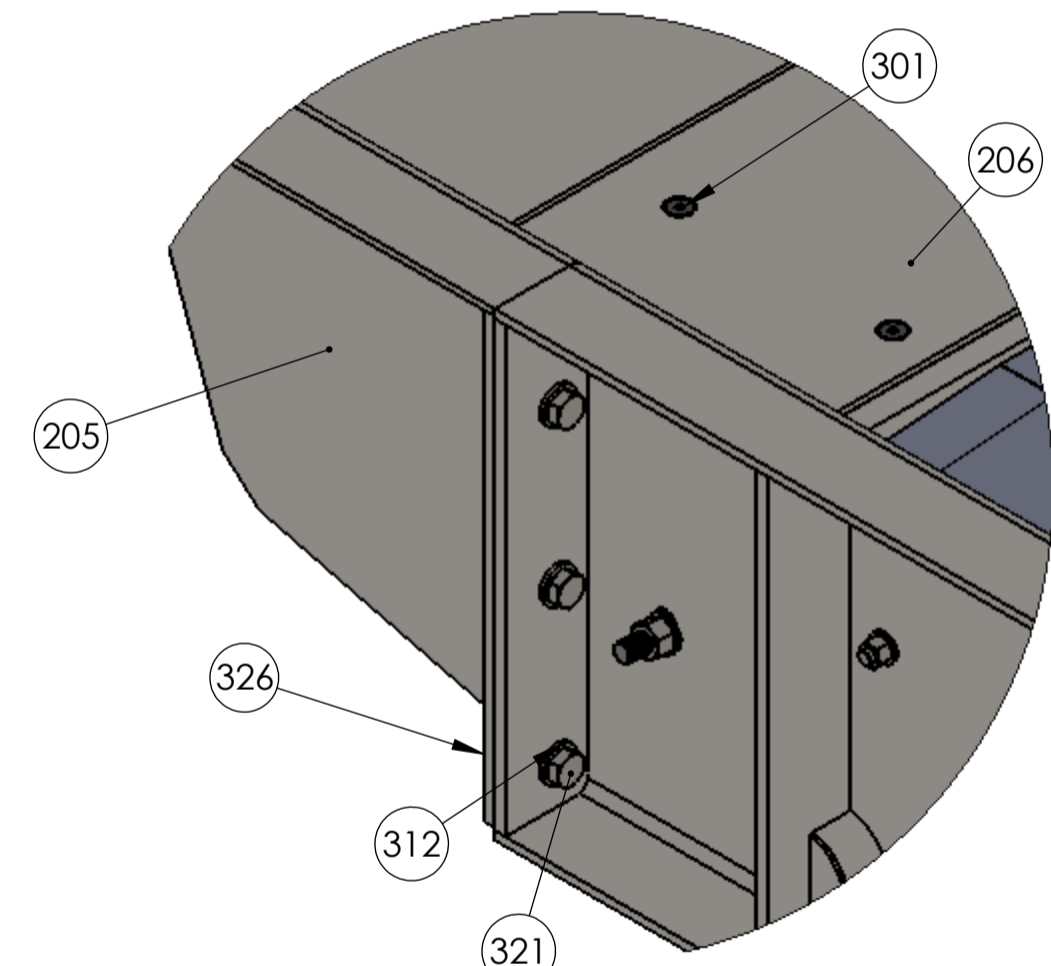

DETAIL J SCALE 1 : 5

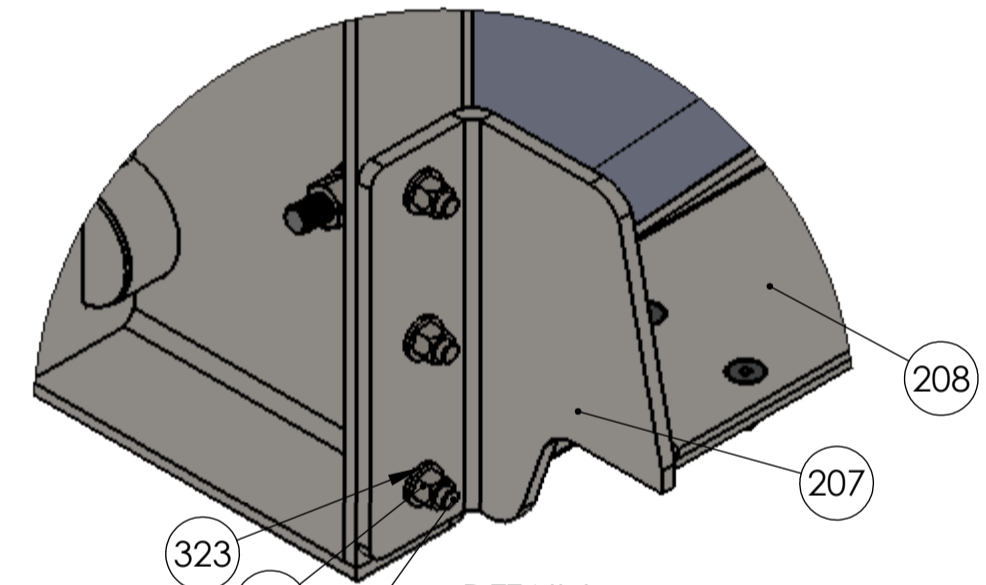

DETAIL I SCALE 1 : 4

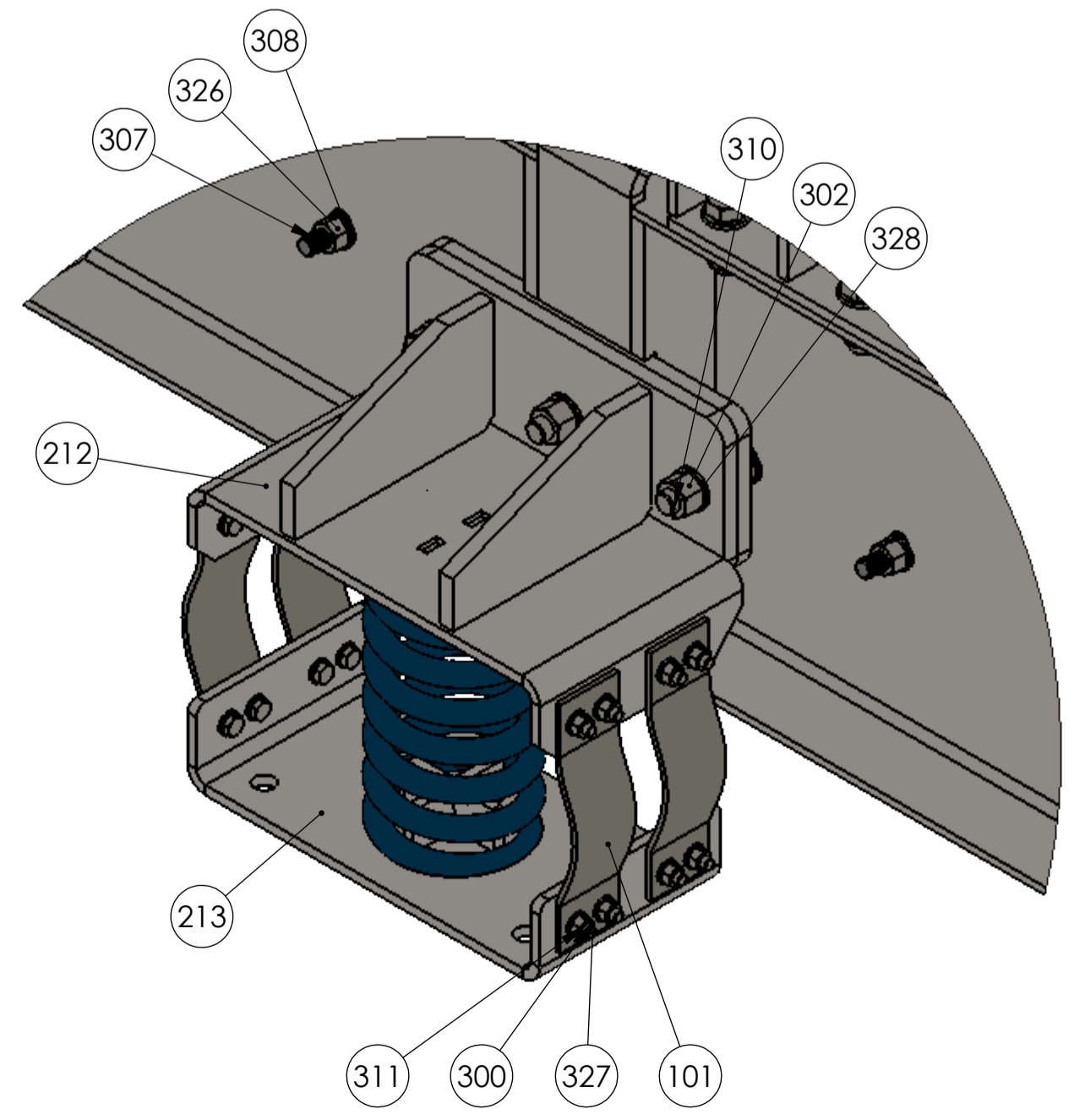

DETAIL F SCALE 1 : 5

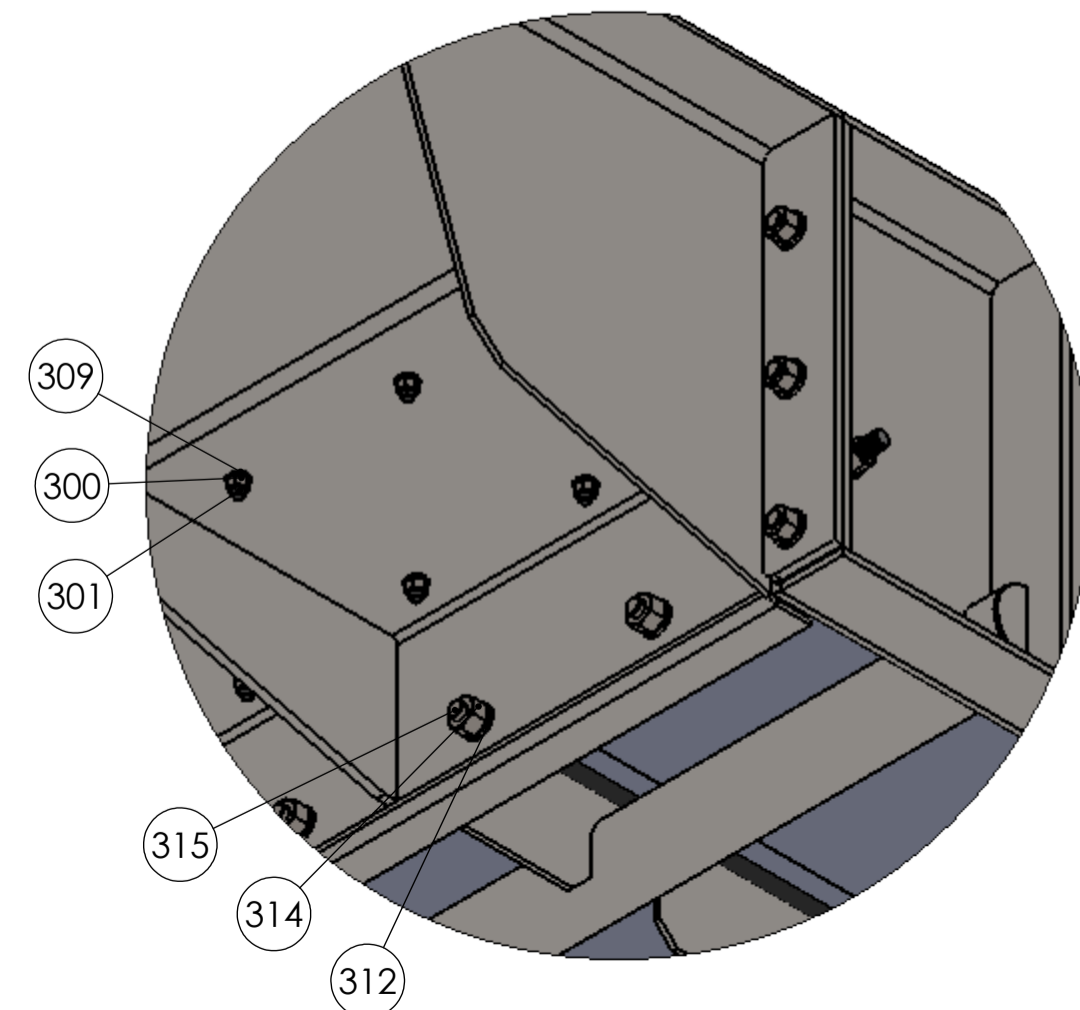

DETAIL N SCALE 1 : 6

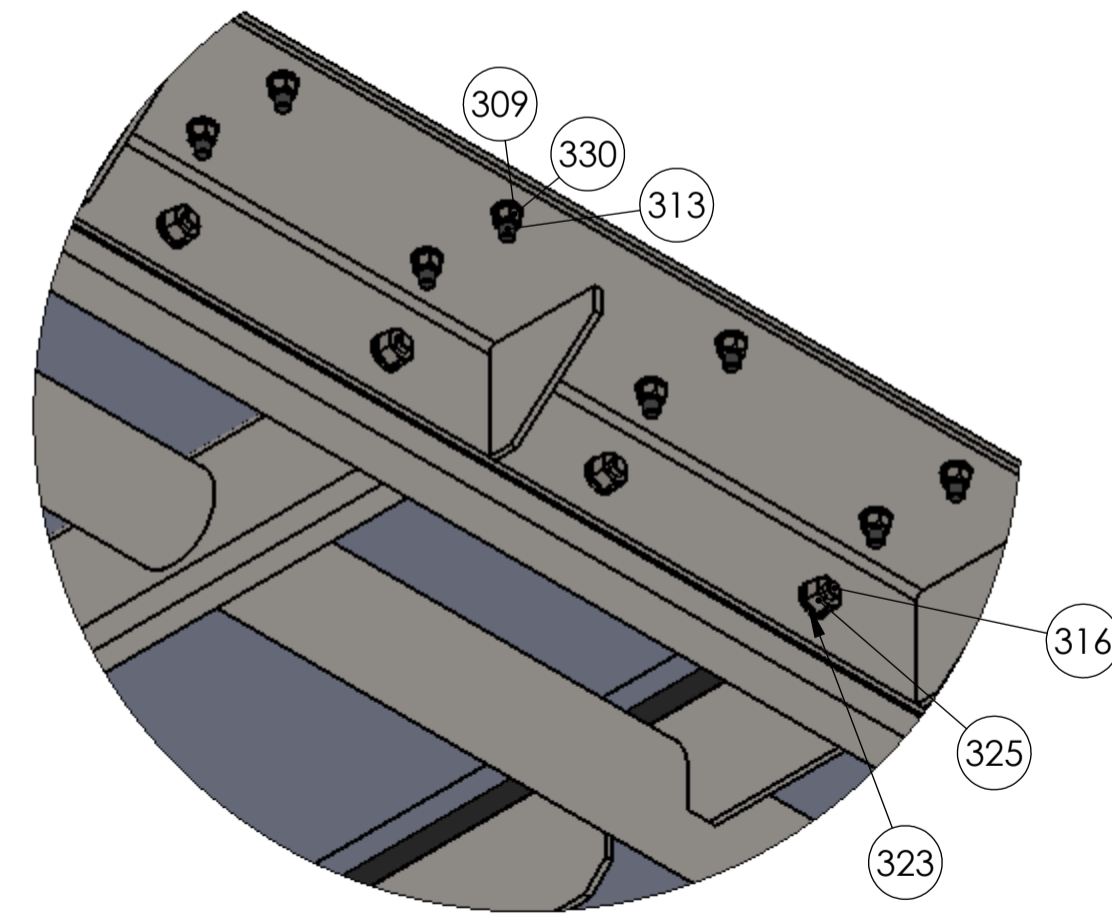

DETAIL M SCALE 1 : 5

UNLESS OTHERWISE SPECIFIED: DIMENSIONS ARE IN MILLIMETERS SURFACE FINISH: TOLERANCES: LINEAR: ANGULAR:				FINISH:	DEBURR AND BREAK SHARP EDGES	DO NOT SCALE DRAWING	REVISION
DRAWN	NAME	SIGNATURE	DATE				
CHKD							
APPVD							
MFG							
G.A.							
MATERIAL:				TITLE: Single Deck Open Elliptical Screen Model SEO1-1830T			
WEIGHT: 2046371.00 Kg				SCALE: 1:15 SHEET 3 OF 3			